

HandKey[®] II

Biometric hand geometry reader



Overview

Nothing is tougher!

Our HandKey II product is ideal for applications where consistent and dependable security is of prime importance. The product is easy to maintain, and provides an ideal mix of convenience, security and peace of mind.

Top 10 reasons to select hand geometry

Field proven reliability

- Hundreds of thousands of HandKeys are installed all over the world in diverse applications, providing millions of error free transactions every day

Convenience and cost savings

- Incredibly fast installation and intuitive enrollment increases user convenience
- Verification in less than one second makes it ideal for high throughput applications
- High product quality + low maintenance costs = low total cost of ownership
- Eliminate the worry of lost, stolen or unauthorized transfer of ID cards plus the cost of purchasing and maintaining these cards

Eliminate privacy concerns

- Hand geometry technology is well accepted by end users, as there are no fingerprints or palm prints taken and the user does not leave behind any trace of their biometric data

Amazing versatility

- HandKeys can be used as standalone systems to protect critical access points that can be easily integrated into virtually every new or existing access control system in the market today
- Ability to customize user-specific security levels, time zones, holidays and languages based on your needs
- Optional access control template management software allows the HandKeys to form a system that communicates alarms and transactions in real time, provides activity reports, allows supervised on-site or remote user enrollment and expiring privileges for temporary access
- Environmental enclosures and integrated heater units make the HandKey an ideal solution for outdoor usage

Features and benefits

- Convenience of multiple credential options such as proximity, magnetic stripe, barcode, HID iCLASS[®] and MIFARE[®]
- Field installable Ethernet module
- Outdoor enclosure options that make the HandKey II an ideal solution for outdoor usage
- Field upgradable and expandable memory options from 512 to 259,072 users for scalable security that grows with your needs
- Three user-definable outputs to connect to auxiliary devices such as audible or silent alarms, door locks or lighting systems
- Ability to write the industry's most compact biometric template on a card instead of in a database results in higher security and unlimited user capacity
- Specially formulated antimicrobial coating with silver ions on the platen to inhibit the growth of bacteria, mold and mildew to mitigate hygiene concerns. The coating is safe and lasts for the life of the product
- Blue hand outline on the platen facilitates easy enrollment and reduces error rates during verification

Door control and monitoring

Each HandKey II is a complete, integrated door controller providing lock operation, request-for-exit and alarm monitoring. Biometric templates and decision-making capability reside locally, ensuring your doors are always secure and will continue to operate properly even if all communication to the main access control system is lost.

Standalone or fully integrated

HandKey readers can be used as a stand-alone unit or as part of an integrated access control system.

The units easily integrate into existing systems using the card reader emulation mode. Or, by using the HandNet software for template management, thousands of units can be linked together to form a

system that communicates alarms and transactions in real time, provides activity, user and systems reports, and allows supervised user enrollment and deletions at any reader. A variety of communications options, including dial-up modems and Ethernet, allow you to design a system that's right for your facilities.

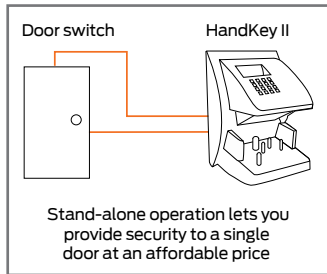

In a network

HandNet software links a virtually unlimited number of HandKey units into an integrated door access control system. All alarms and transactions report back in real time to the central computer, making door and alarm monitoring easy and efficient. Activity, user and system reports can be easily generated. The central computer handles all hand template management allowing supervised enrollment at any reader and system wide deletions. An optional internal modem lets you include remote site operations. Ethernet communication is also available.

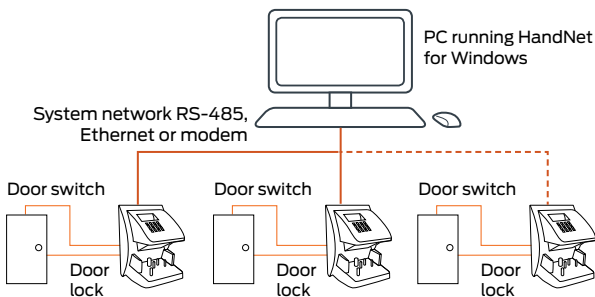

Base model	HandKey II
Description	HandKey with base memory for 512 users
Verification time	≤ 1 second for comparison to reference template
ID number length	1 – 10 digits
Duress code	1 leading digit, user definable
Communication	RS232: Baud rate 300 bps to 28,800 bps RS422: Baud rate 300 bps to 28,800 bps RS485: Baud rate 300 bps to 28,800 bps Optional modem: Baud rate 300 bps to 14,400 bps Optional ethernet: 10 Base T
Template Size	9 bytes
User memory	512 users field expandable up to 32,512 users Memory module upgrade up to 259,072 users
Inputs	Standard: 26 bit, 9 bit ID Wiegand Optional: Mag stripe, bar code, smart card HandKey input: Request-to-exit, door switch input, 2 auxiliary inputs
Outputs	Door control: Lock output Card reader emulation mode: Wiegand, mag stripe, bar code 1 programmable auxiliary Outputs to peripheral devices: Audible or silent alarms, door locks, lighting systems
Event monitoring	Tamper: HandKey opened or removed ID refused: User not verified after user definable number of tries exceeded Duress: User entered duress code digit Power failure: HandKey switched to optional battery power
Programmable HandKey commands	<ul style="list-style-type: none"> ▪ Add / remove users ▪ Set global operating thresholds ▪ Set individual user data (authority or threshold levels, time zones) ▪ Transmit data from master to remote ▪ Data received by master from remote ▪ Transmit / receive data from optional software ▪ Check status of door (tamper, door monitor switch) ▪ Time zones – 62 total (2 fixed, 60 programmable) ▪ Set language ▪ Set date format, date and time ▪ Edit holidays
Antimicrobial	Available on platen
Blue hand outline	Available on platen
Dimensions H x W x D	11.65 in x 8.85 in x 8.55 in 29.6 cm x 22.5 cm x 21.7 cm
Power requirements	12 to 24 VDC or 12 to 24 VAC 50-60 Hz 7 Watts (without options)
Weight	5.3 lbs (2.4 kgs.) Without battery back-up or wall plate
Temperature	Operating: 0° - 45°C / 32° - 113°F Non-operating (storage): -10° - 60°C / 14° - 140°F
Relative humidity	Operating: 20% to 80% RH non-condensing Non-operating (storage): 5% to 85% RH Non-condensing

EntraPASS.com